

Disabled access to Town Hall/ CSC

Back entrance onto Lion Street

Access arrangements to be agreed

No access - door locked

No access, doors locked unless an emergency



Old police door entrance (not DDA compliant)

Customer Service Centre

Break-out Area

Customer Contact Centre

KEY

-  Original masonry walls
-  Masonry walls constructed in 2004/13
-  Lightweight partition walls constructed in 2004/13

All to be checked and confirmed on site



IPSWICH
BOROUGH COUNCIL

Title		Ground Floor Plan Existing Layout	
Project		Ipswich Town Hall Ground Floor Unit	
Drawing no.	22.14.100	Rev	-
Date	11.22	Scale	1:50 @ A1

DRAFT

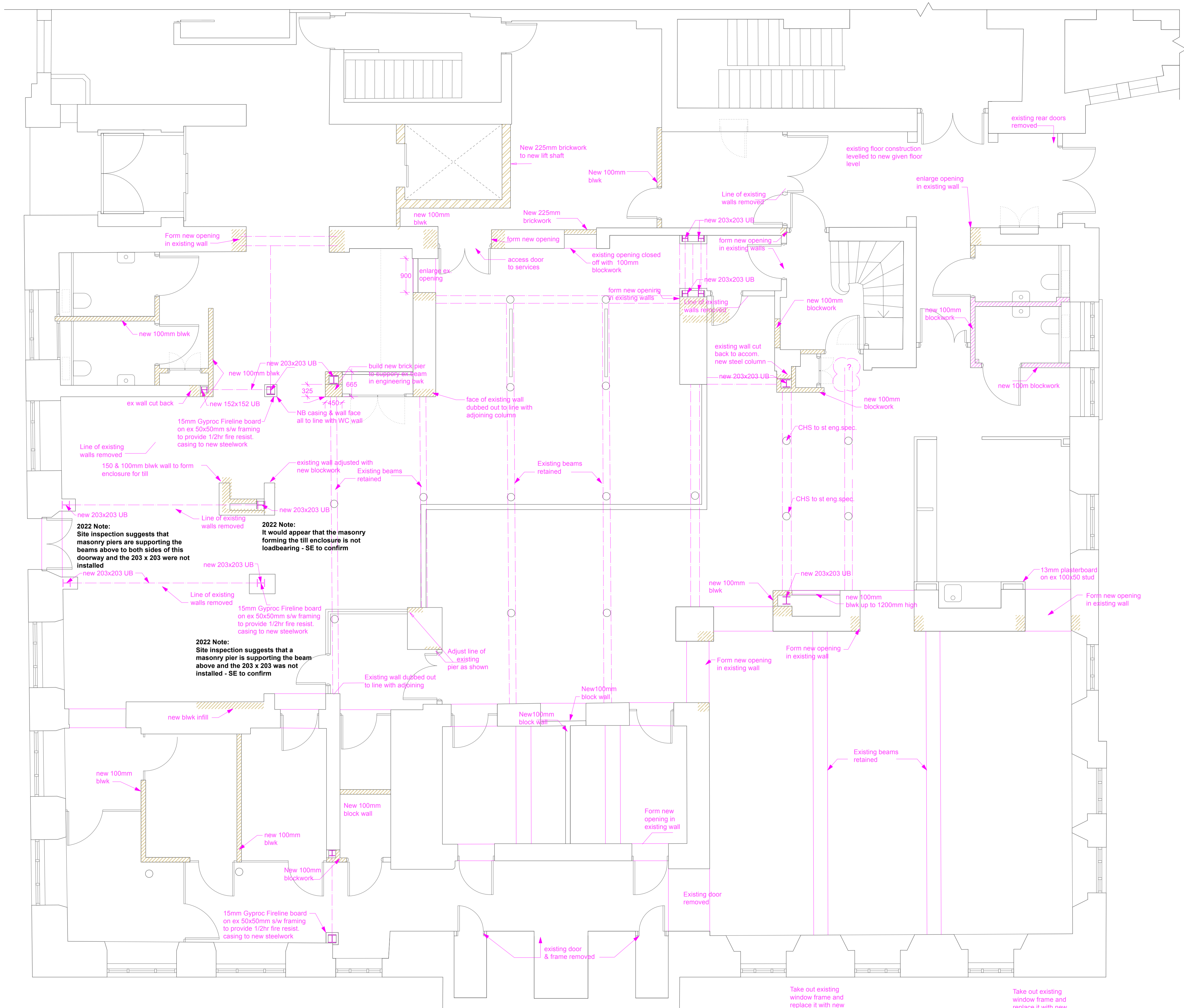

Floor plan overlaid with the following drawing:

MRDA Architects
 IPSWICH TOWN HALL - PHASE II REFURBISHMENT
 GROUND FLOOR DEMOLITION PLAN
 1225-10
 AL-21 Rev. G
 November 2004



IPSWICH
BOROUGH COUNCIL

Title	Ground Floor Plan Structure and Demolitions	
Project	Ipswich Town Hall Ground Floor Unit	
Drawing no.	22.14.101	Rev -
Date	11.22	Scale 1:50 @ A1

DRAFT

Do not scale from this drawing. All dimensions must be checked and verified on site before commencing any work

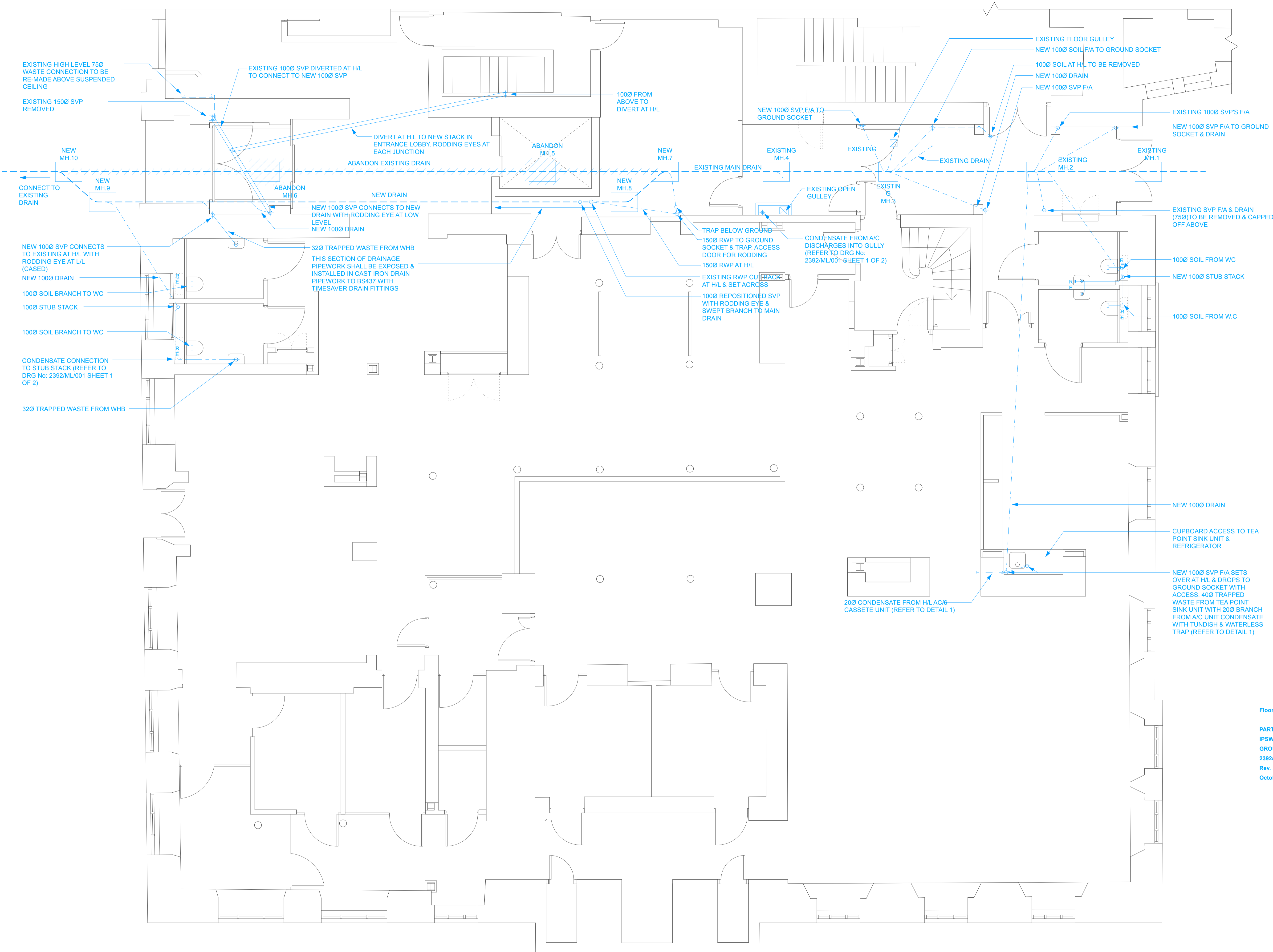

Floor plan overlaid with the following drawing:

PARTNERSHIP DESIGN
 IPSWICH TOWN HALL - REVISED SCHEME
 GROUND FLOOR PROPOSED DRAINAGE LAYOUT
 2392/PH/001
 Rev. 3
 October 2004

DRAFT

**IPSWICH
BOROUGH COUNCIL**

Title	Ground Floor Plan Drainage	
Project	Ipswich Town Hall Ground Floor Unit	
Drawing no.	22.14.102	Rev. -
Date	11.22	Scale 1:50 @ A1

Do not scale from this drawing. All dimensions must be checked and verified on site before commencing any work